

E PLAZA & RESIDENCES

6723 KENNEDY BLVD
NORTH BERGEN, NJ 07047

NEW RETAIL AVAILABILITY

3,000 SF TOTAL AVAILABLE SPACE / VENTING ABILITY / HIGH POPULATION DENSITY / HEAVY TRAFFIC

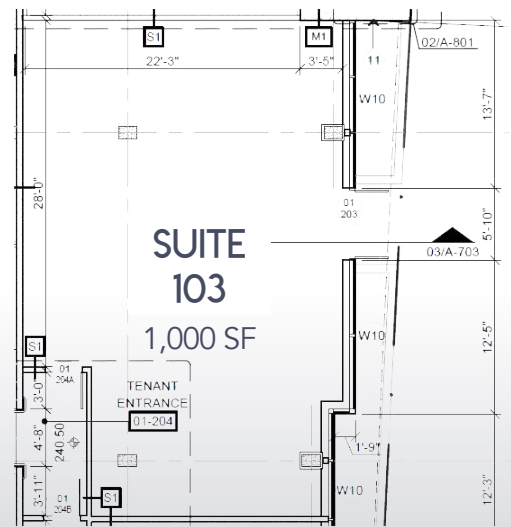
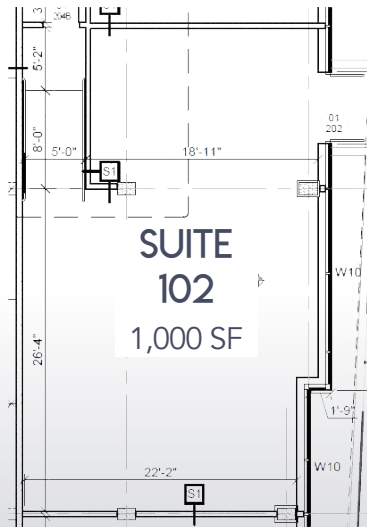
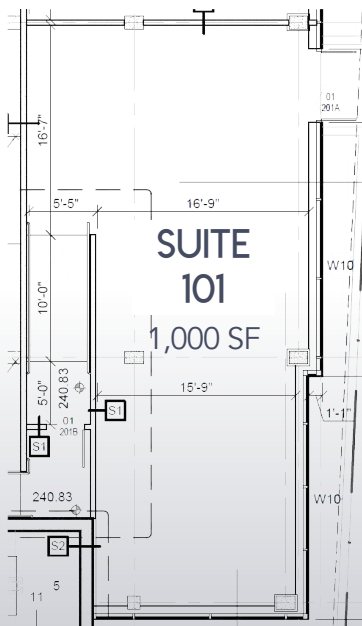

COLLIERS INTERNATIONAL NJ LLC

300 Interpace Parkway Bldg C, 3rd Floor, Parsippany, NJ 07054 | colliers.com

No representation is made as to the accuracy of the information furnished herein and same is submitted subject to errors, omissions, change of prices, rental, or other conditions, prior sale, lease, sublease, and/or withdrawal without notice. The furnishing of this information shall not be deemed a hiring. A commission in accordance with our principal's schedule of rates and conditions will be paid to the procuring Broker who executes our or our principal's brokerage agreement, subject to a fully consummated transaction upon terms and conditions acceptable to our principal.

6723 KENNEDY BLVD
NORTH BERGEN, NJ 07047



3,000 SF
TOTAL
AVAILABLE

SPACE FEATURES

- Three suites, approx. 1,000 SF each
- Ability to Combine Suites
- Venting Available
- Rent Upon Request

PROPERTY HIGHLIGHTS

- Brand-New Mixed-Use Development
- 52 Luxury Apartments
- High Population Density
- Heavy Traffic: 23,680 VPD

CONTACT:

NANCY ERICKSON, MBA
Executive Managing Director
Retail Services
Broker Salesperson NJ NY FL
Mob +1 908-803-8622
nancy.erickson@colliers.com

LOCAL DEMOGRAPHICS

	1 Mile Ring	2 Mile Ring
POPULATION TREND		
2018 Total Population	93,276	197,351
2023 Total Population	95,813	204,176
HOUSEHOLDS TREND		
2018 Total Households	32,166	73,025
2023 Total Households	32,273	74,068
Total Daytime Population	66,470	156,987
Total Employee Population	17,609	58,021
Total Daytime at Home Population	48,861	98,966



COLLIERS INTERNATIONAL NJ LLC

300 Interpace Parkway Bldg C, 3rd Floor, Parsippany, NJ 07054 | colliers.com

No representation is made as to the accuracy of the information furnished herein and same is submitted subject to errors, omissions, change of prices, rental, or other conditions, prior sale, lease, sublease, and/or withdrawal without notice. The furnishing of this information shall not be deemed a hiring. A commission in accordance with our principal's schedule of rates and conditions will be paid to the procuring Broker who executes our or our principal's brokerage agreement, subject to a fully consummated transaction upon terms and conditions acceptable to our principal.