



Northcrest I

Joe Owen CCIM, SIOR
Senior Vice President
+1 952 897 7888
joe.owen@colliers.com

Corbin Chapman
Associate
+1 952 374 5811
corbin.chapman@colliers.com

1600 Utica Avenue S, Suite 300
St. Louis Park, MN 55416
+1 952 897 7700
colliers.com/msp

7501-7561 Washington Ave S
Eden Prairie, MN

**Open warehouse space with excellent
visibility to Highway 169**

- Flexible small bay space
- Excellent location in Southwest market
- Exceptional visibility to 85,000 vpd on Highway 169

Copyright © 2021 Colliers International. Information herein has been obtained from sources deemed reliable, however its accuracy cannot be guaranteed. The user is required to conduct their own due diligence and verification.

For Lease

Building Information

Address:	7501-7561 Washington Avenue S Eden Prairie, MN		
Clear Height	18'		
Parking	5/1,000 SF parking ratio		
Currently Available: Suite 7521 Available 10/1/2021	Office	1,059 SF	
	Mazzanine/Office	997 SF	
	Warehouse	2,724 SF	
	Total	4,780 SF	
Loading	One dock door		
Net Lease Rate	\$12.00 PSF office \$6.00 PSF warehouse		
Est. CAM & Tax (2021)	\$1.58 PSF CAM		
	\$1.75 PSF Tax		
	\$3.33 PSF Total		



Building Plan

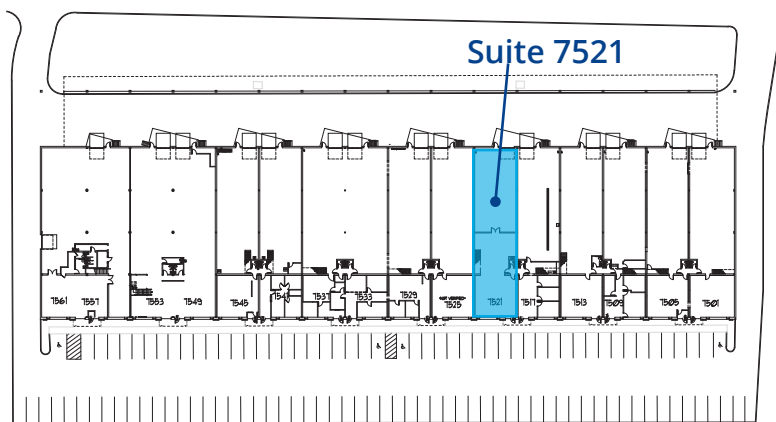

Second Floor

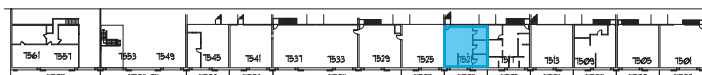

Joe Owen CCIM, SIOR

Senior Vice President
+1 952 897 7888
joe.owen@colliers.com

Corbin Chapman

Associate
+1 952 374 5811
corbin.chapman@colliers.com

1600 Utica Avenue S, Suite 300
St. Louis Park, MN 55416
+1 952 897 7700
colliers.com/msp