



55 WATER STREET

NORTH BUILDING | NEW YORK, NY

Entire 4th - 8th Floors | Total SF: 163,079 SF | Sublease | Term : Thru October 2035

Colliers
INTERNATIONAL

SPACE FEATURES

4 th Floor	34,343 SF
5 th Floor	33,480 SF
6 th Floor	32,616 SF
7 th Floor	31,752 SF
8 th Floor	30,888 SF

Entire 4th - 8th Floors 163,079 SF (Total)
Sublease Term Thru October 2035

- Upgraded installation featuring: Glass office fronts, new LED lighting, new carpet and paint throughout, and updated restrooms
- Opportunity to access 3rd Floor Fuel Stop (Coffee Bar + Micro-mart) amenity and Concourse level Fitness Center
- Access to the Elevated Acre outdoor garden and café with grab and go dining
- Floors may be leased together or separately
- Existing furniture systems are positioned with 6' distancing guidelines
- Available for immediate occupancy
- Immediate access to ferries, and close proximity to subways
- Direct access to 600 car covered parking garage
- CitiBike in close proximity

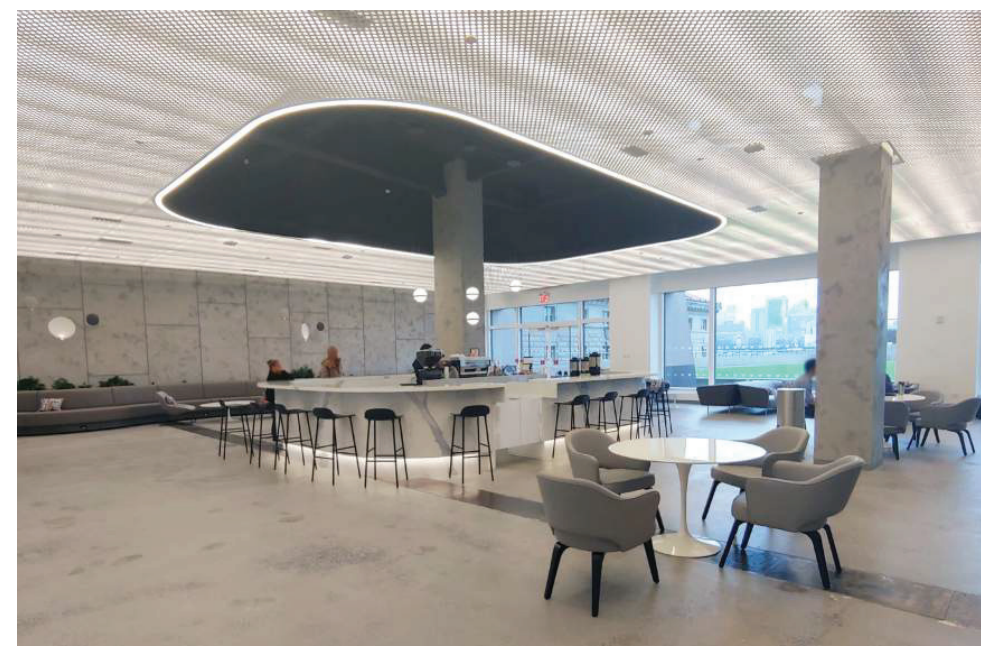

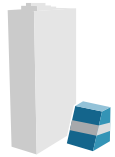

North Tower

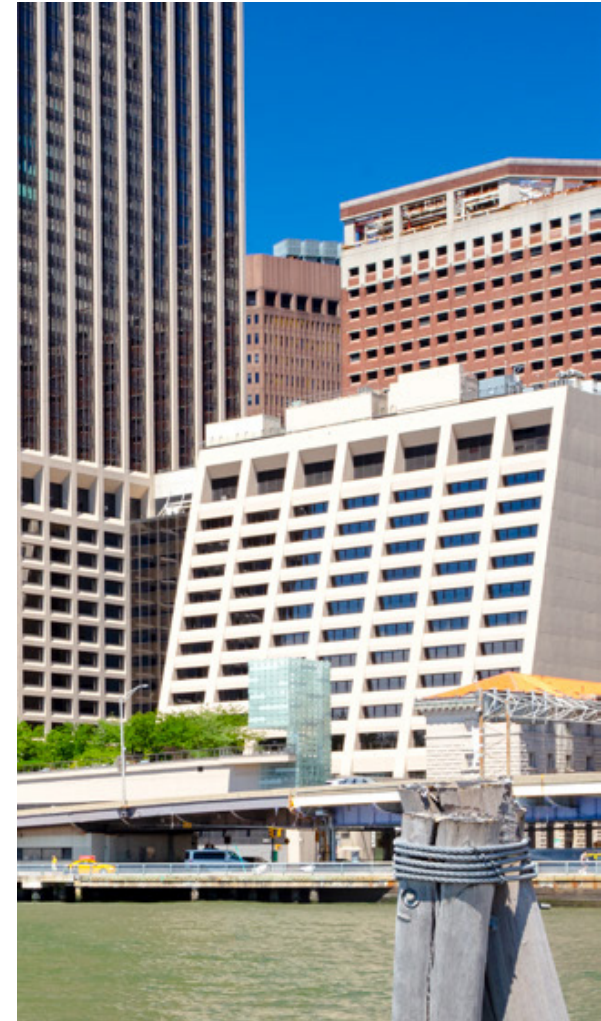
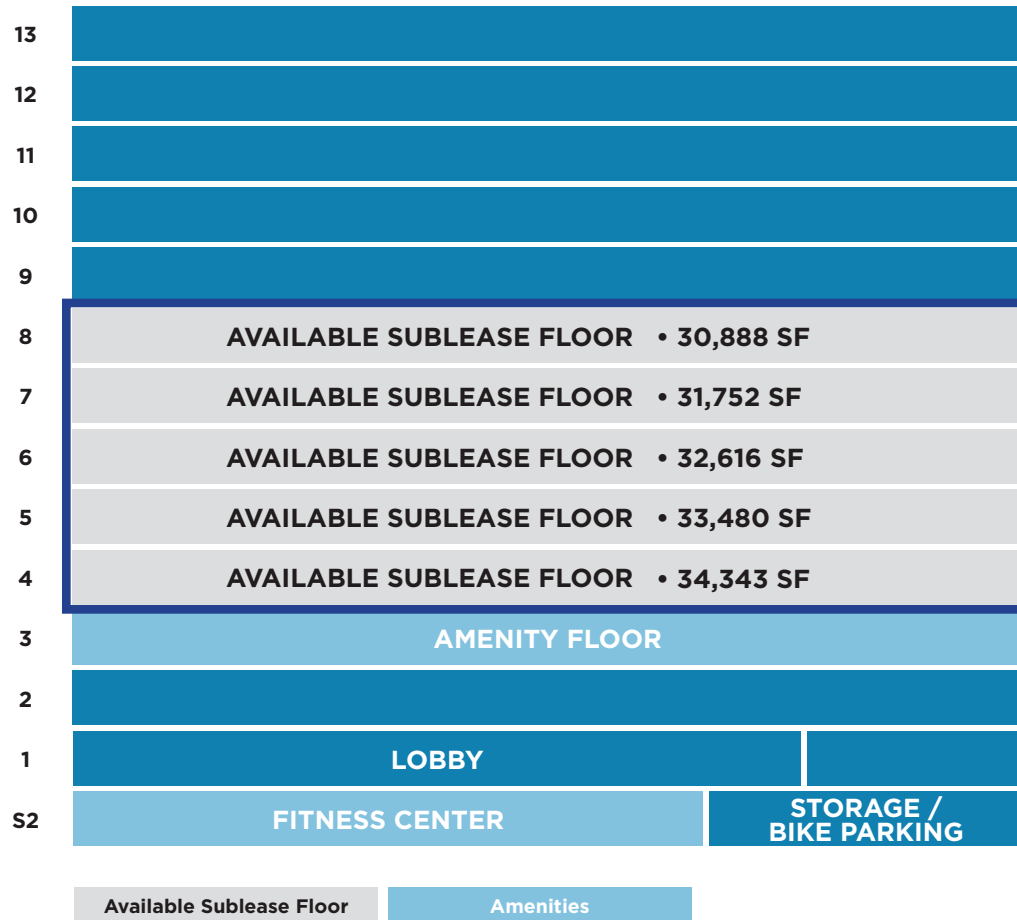



As a note, the attached plan reflects very closely the current conditions of the floor, but a full detailed survey has not been conducted. The workstation system on the floor does have the ability to be customizable and the module of the station sizes shown could be modified as long as they work along the increments provided in the current system.

- ### ENTIRE 8TH FLOOR
- Offices: Nineteen (19) Total
 - Large: Four (4)
 - Regular: Fifteen (15)
 - Conference Rooms: Seven (7) Total
 - Large: Two (2)
 - Small / Huddle Room: Four (4)
 - Team Room (10-person): One (1)
 - Break-Out Spaces: Five (5)
 - Desks: 121 seats
 - Copy / Print / Mail Room: Two (2)
 - Large Eat-in Pantry: One (1)
 - Reception Area
 - Storage Closet: One (1)
 - Electrical Closet: One (1)

LEGEND

	OFFICE SLARGE		COLLABORATION
	WORKSTATION "A"		PANTRY
	WORKSTATION "B"		SUPPORT
	WORKSTATION "C"		

6'-0" diameter circles provide a visual reference for current spacing in the plan between existing seats

N Drawing Not to Scale

WATER STREET

EAST RIVER

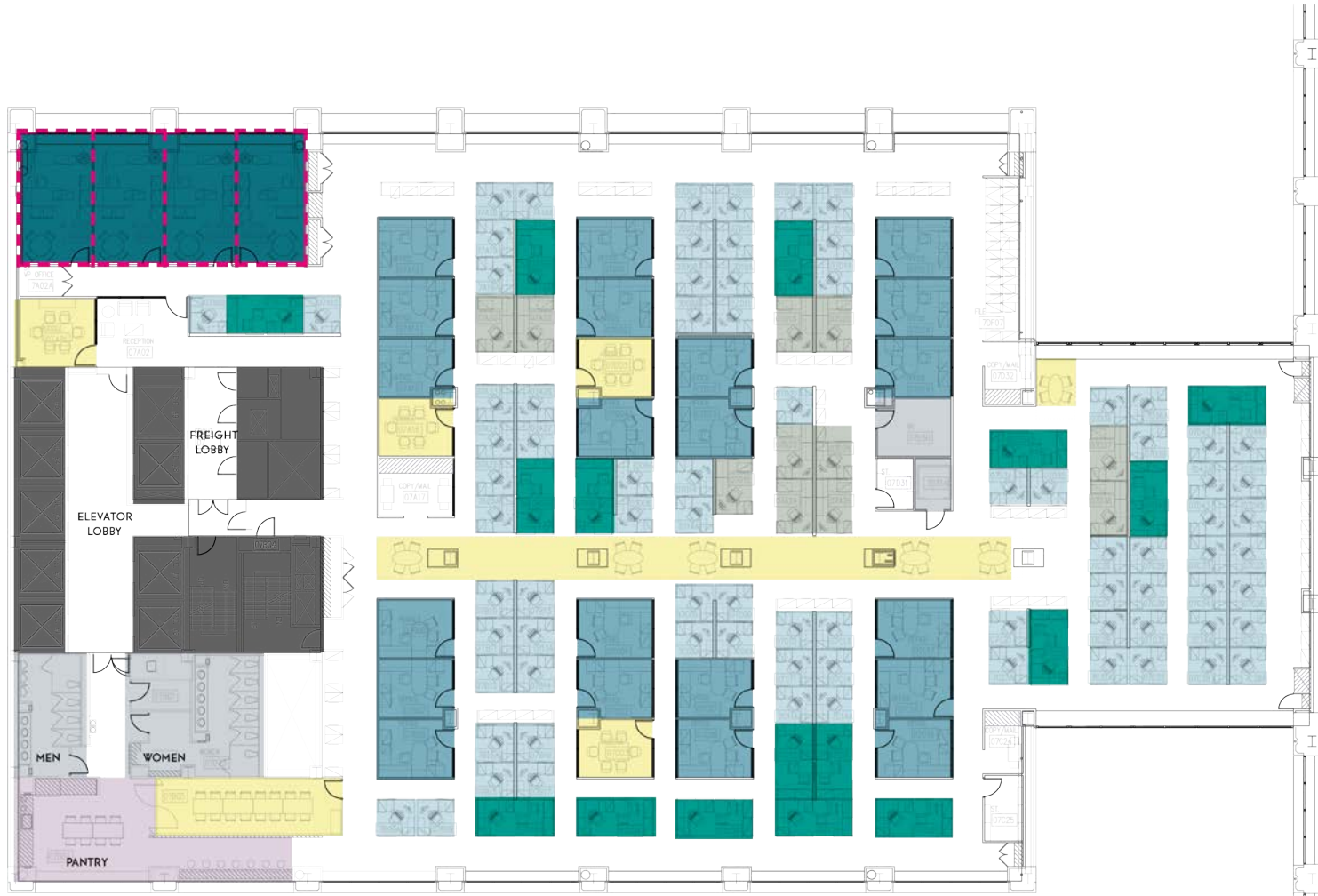

As a note, the attached plan reflects very closely the current conditions of the floor, but a full detailed survey has not been conducted. The workstation system on the floor does have the ability to be customizable and the module of the station sizes shown could be modified as long as they work along the increments provided in the current system.

- ### ENTIRE 7TH FLOOR
- Offices: Twenty-Four (24) Total
 - Large: Four (4)
 - Regular: Twenty (20)
 - Conference Rooms: Six (6) Total
 - Large: One (1)
 - Small / Huddle Room: Five (5)
 - Break-Out Spaces: Six (6)
 - Desks: 106 seats
 - Copy / Print / Mail Room: Two (2)
 - Large Eat-in Pantry: One (1)
 - Reception Area
 - Storage Closet: One (1)
 - Electrical Closet: One (1)

LEGEND

- | | |
|---|---|
| OFFICE SLARGE | COLLABORATION |
| WORKSTATION "A" | PANTRY |
| WORKSTATION "B" | SUPPORT |
| WORKSTATION "C" | |

WATER STREET

N —
Drawing Not to Scale

EAST RIVER



As a note, the attached plan reflects very closely the current conditions of the floor, but a full detailed survey has not been conducted. The workstation system on the floor does have the ability to be customizable and the module of the station sizes shown could be modified as long as they work along the increments provided in the current system.

- ### ENTIRE 6TH FLOOR
- Offices: Thirteen (13) Total
 - Large: Two (2)
 - Regular: Eleven (11)
 - Conference Rooms: Five (5) Total
 - Board Room (25-person): One (1)
 - Large: One (1)
 - Small / Huddle Room: Two (2)
 - Team Room (10-person): One (1)
 - Break-Out Spaces: Five (5)
 - Desks: 138 seats
 - Copy / Print / Mail Room: Two (2)
 - Large Eat-in Pantry: One (1)
 - Reception Area
 - Storage Closet: One (1)
 - Electrical Closet: One (1)

LEGEND

- | | |
|-----------------|---------------|
| OFFICE SLARGE | COLLABORATION |
| WORKSTATION "A" | PANTRY |
| WORKSTATION "B" | SUPPORT |
| WORKSTATION "C" | |

N Drawing Not to Scale

WATER STREET







EAST RIVER



As a note, the attached plan reflects very closely the current conditions of the floor, but a full detailed survey has not been conducted. The workstation system on the floor does have the ability to be customizable and the module of the station sizes shown could be modified as long as they work along the increments provided in the current system.

- ### ENTIRE 5TH FLOOR
- Offices: Twenty-Two (22) Total
 - Large: Four (2)
 - Regular: Eleven (11)
 - Conference Rooms: Four (4) Total
 - Large: Three (3)
 - Small / Huddle Room: One (1)
 - Break-Out Spaces: Six (6)
 - Desks: 125 seats
 - Copy / Print / Mail Room: Two (2)
 - Large Eat-in Pantry: One (1)
 - Reception Area
 - Storage Closet: One (1)
 - Electrical Closet: One (1)

LEGEND

 OFFICE SLARGE	 COLLABORATION
 WORKSTATION "A"	 PANTRY
 WORKSTATION "B"	 SUPPORT
 WORKSTATION "C"	

N  Drawing Not to Scale

WATER STREET

EAST RIVER



As a note, the attached plan reflects very closely the current conditions of the floor, but a full detailed survey has not been conducted. The workstation system on the floor does have the ability to be customizable and the module of the station sizes shown could be modified as long as they work along the increments provided in the current system.

ENTIRE 4TH FLOOR LAYOUT

- Offices: Seventeen (17) Total
 - Large: Four (4)
 - Regular: Thirteen (13)
- Conference Rooms: Four (4) Total
 - Large: Three (3)
 - Small: One (1)
- Desks: 161 seats
- Copy / Print / Mail Room: Two (2)
- Large Eat-in Pantry: One (1)
- Reception Area
- Storage Closet: One (1)
- Electrical Closet: One (1)

LEGEND

OFFICE SLARGE	COLLABORATION
WORKSTATION "A"	PANTRY
WORKSTATION "B"	SUPPORT
WORKSTATION "C"	

Drawing Not to Scale

WATER STREET

Concourse Level – Fitness Center



AdvantageCare  Medical Center
PHYSICIANS



3RD FLOOR:

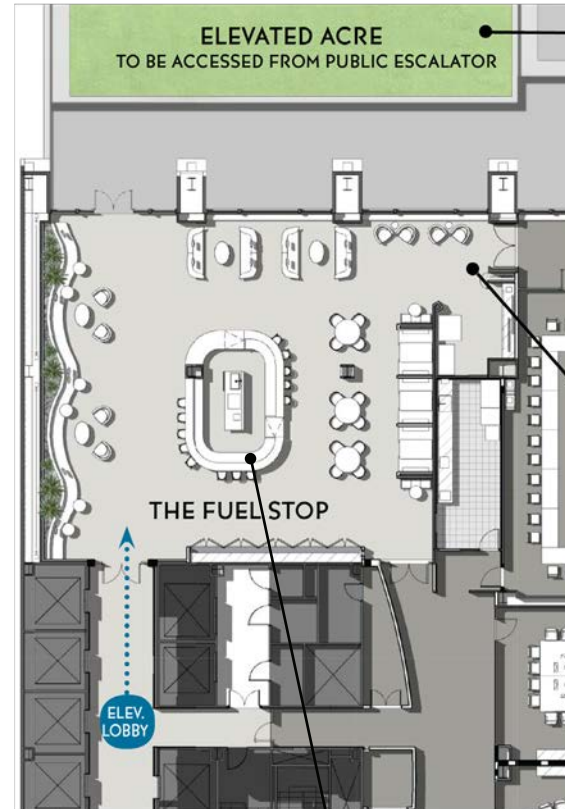

MICRO-MART
SELF-SERVE MARKET



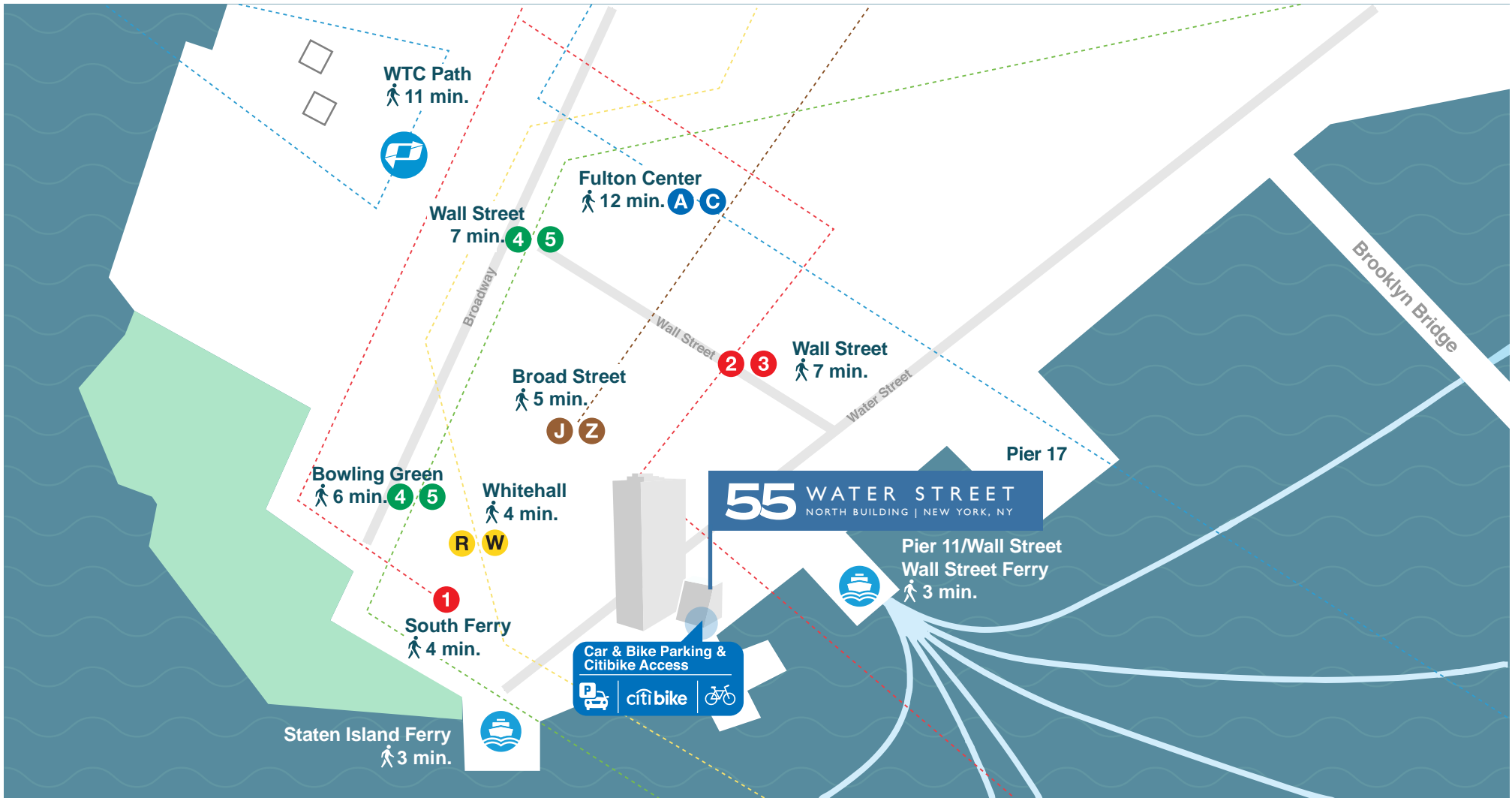

55 WATER STREET

NORTH BUILDING | NEW YORK, NY

BRIAN GIVEN

Associate Real Estate Broker
+1 212 716 3518
brian.given@colliers.com

SHEENA GOHIL

Real Estate Salesperson
+1 212 716 3828
sheena.gohil@colliers.com

JACK SENSKE

Real Estate Salesperson
+1 212 716 3668
jack.senske@colliers.com

AIDAN CAMPBELL

Real Estate Salesperson
+1 212 716 3825
aidan.campbell@colliers.com

STEVEN JARAY

Real Estate Salesperson
+1 212 716 3806
steven.jaray@colliers.com

No representation is made as to the accuracy of the information furnished herein and same is submitted subject to errors, omissions, change of prices, rental, or other conditions, prior sale, lease, sublease, and/or withdrawal without notice. The furnishing of this information shall not be deemed a hiring. A commission in accordance with our principal's schedule of rates and conditions will be paid to the procuring Broker who executes our or our principal's brokerage agreement, subject to a fully consummated transaction upon terms and conditions acceptable to our principal.

Colliers
INTERNATIONAL